

Miami 208

FRONTAGE
12.5m

LENGTH 23.25m
WIDTH 11.05m

TOTAL FLOOR AREA
207.81m²

-  4
-  2
-  2
-  2

| | |
|----------|-----------|
| Bed 1 | 4.0 x 3.3 |
| Bed 2 | 3.1 x 3.0 |
| Bed 3 | 3.1 x 3.0 |
| Bed 4 | 3.1 x 3.0 |
| Alfresco | 4.0 x 3.0 |

208

| | |
|---------|-----------|
| Media | 4.0 x 3.4 |
| Meals | 4.7 x 2.2 |
| Kitchen | 3.6 x 2.7 |
| Living | 4.7 x 3.6 |
| Garage | 5.8 x 5.8 |

MIAMI 208 OPTIONS



BARN DOORS TO MEDIA



SPLASHBACK WINDOW

1.8m splashback window to kitchen option



GRAND ALFRESCO UPGRADE

2.89m x 4070m (11.76m²) alfresco addition

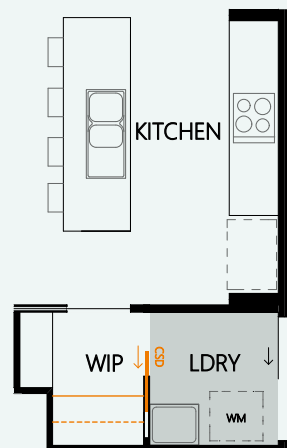

WALK IN PANTRY UPGRADE

+ stone bench
+ overhead cupboards
+ pocket door

